

WINTER 2020  
UPDATE & APPEAL



*Growing Together*  
AS A FAMILY OF FAITH

St. Patrick Parish • Malvern, PA

*Serve* ———  
Together



*Pray* ———  
Together



*Learn* ———  
Together





*The Lord **has** begun a great work in our hearts.  
Let us continue to carry it forward into  
our growing Community of Faith!*

# Join us as we continue on our journey to better serve all members of St. Patrick Parish: **Growing Together as a Family of Faith**

## Working Together to Reach Our Goal

We are blessed to continue to grow as a parish and as people of faith. Responding always to the evolving needs of our increasingly engaged parish family, we encourage more people to join our ministries, celebrate the sacraments, and enroll their children in St. Patrick School and PREP.

Thanks to the contributions of our generous parish family, we have raised nearly \$4M and completed the first half of our Special Appeal. **With two critical phases ahead, we are ready to move forward and need your support to reach our goal of \$6M.**



# Our Evolving Parish Campus

- **March 2018**  
*Special Appeal is launched*
- **August 2018**  
*Phase I Completed:  
New Parish Offices*
- **October 2019**  
*Phase II Completed:  
Playground for Parish Children*

## Phase III

*Target Completion: 2021  
Early Childhood Education Center*

## Phase IV

*Target Completion: 2022  
Spirituality Center*

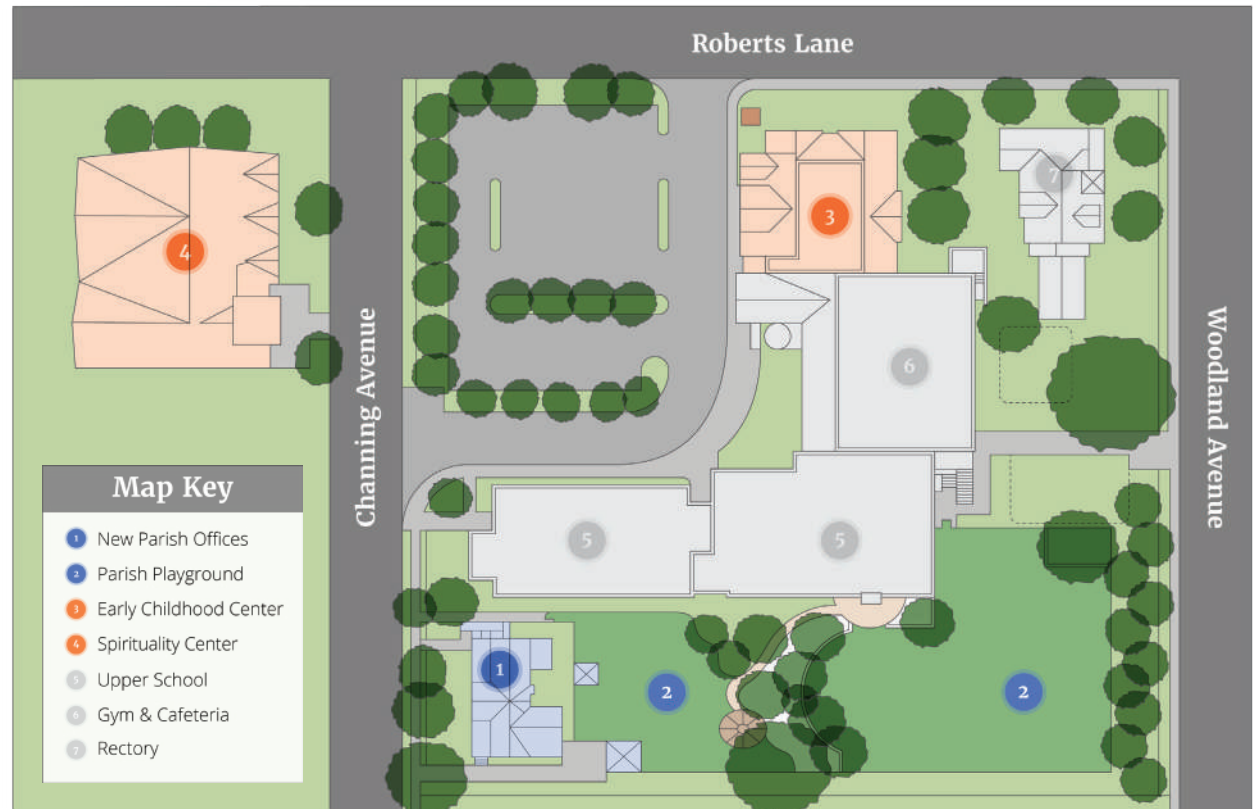

# Our Newest Additions



## Phase I: New Parish Offices

With your help, we launched our Growing Together as a Family of Faith Appeal and completed renovations to the Channing Avenue property. These renovations enable our active parish staff to better serve the needs of the parish, and our pastoral staff to minister in private offices where our parish family can be counseled, guided, and consoled.

This new space allows us to:



**Gather our parish staff** under one roof



**Connect our clergy** directly to St. Patrick Parish in a more convenient and central location



**Create private, comfortable spaces** for the spiritual support and guidance of parishioners



Allow staff and clergy to **better serve and minister to our growing parish family**



# Our Newest Additions



## Phase II: Parish Playground

We also built a playground area for young parishioners in place of the old Woodland Avenue offices and added a new roof onto St. Patrick School to support central air conditioning installation planned for summer 2020.

With this phase completed, we can now:



**Provide a safe place** in which our parish children can play together



**Offer two separate playground areas**, one for young children and one for older children



**Create a recess space** for St. Patrick School children



Allow St. Patrick's teachers, catechists and students to **work and learn in a comfortable environment**

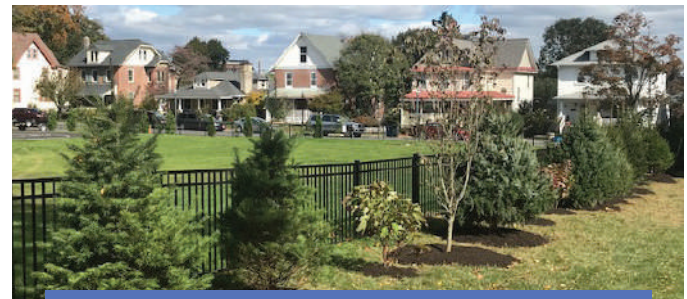



# A Closer Look at Our New Playground

## A play area fit for our children.

A lot of hard work and planning goes into building a playground. To ensure the safety of our young parishioners, we were required to hire...

- ▶ **Geo-technical Engineers**
- ▶ **Civil Engineers**
- ▶ **Builder / Construction Company**
- ▶ **Fencing Company**
- ▶ **Landscape Architects**

In creating our new playground, we...

- ▶ Demolished **two buildings**
- ▶ Added almost **60 new trees and plantings**
- ▶ Purchased and installed **jungle gyms**
- ▶ Installed a **water basin**
- ▶ Installed **safety fencing**
- ▶ Removed the **utility pole** and **manhole** in the middle of the field
- ▶ Graded the field to a **flatter surface**
- ▶ **Resurfaced** the entire field
- ▶ Installed a **basketball court** and **hoop**

# What's Next?

## III

### Phase Three: Early Childhood Education Center

We are forecasting our largest enrollment in 14 years for the 2020-21 school year, with healthy enrollment across each class from PK3 through 8th grade, while maintaining our current small class sizes.

As our school community continues to thrive, we forecast a further increase in enrollment during the upcoming years and will maintain the small student-teacher class ratio. Currently, St. Patrick boasts its largest Kindergarten class, filled with long-term St. Patrick School families. **The hope for our school, as we move forward, is to continue to have a healthy, vibrant, and financially stable parish school.** The new addition will:



**Provide eight classrooms** for our school and PREP students



**Create ample continuous learning space** for our parish's youngest members



**Eliminate the need** for young students to use the church basement



**Enhance the faith-based education** of St. Patrick School students, as well as PREP students



# What's Next?

## IV

### Phase Four: Spirituality Center

Finally, we will build a Spirituality Center underneath the church, complete with space to feed the fire of our faith and support growing ministries and formation programs. This phase will:



Include **five spacious ministry meeting rooms**



Provide permanent office space for **Amigos de Jesús, an orphanage that takes in impoverished children** and instills the values of Jesus Christ within them



**Foster the growth** of our parish ministries and encourage faith formation



**Enable ministry groups of all sizes** to meet on St. Patrick Parish's campus, now and for years to come



**Provide much-needed prayerful conference areas** for group meetings



**Continually welcome new members** into growing ministry groups

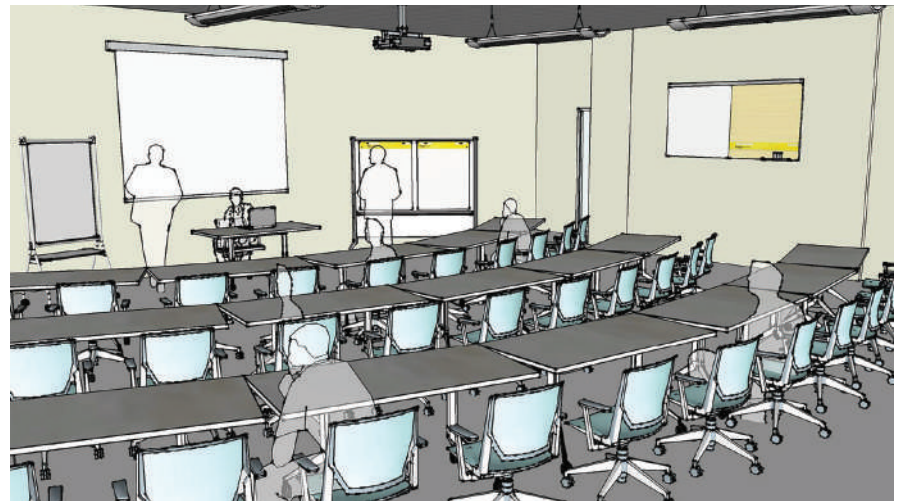
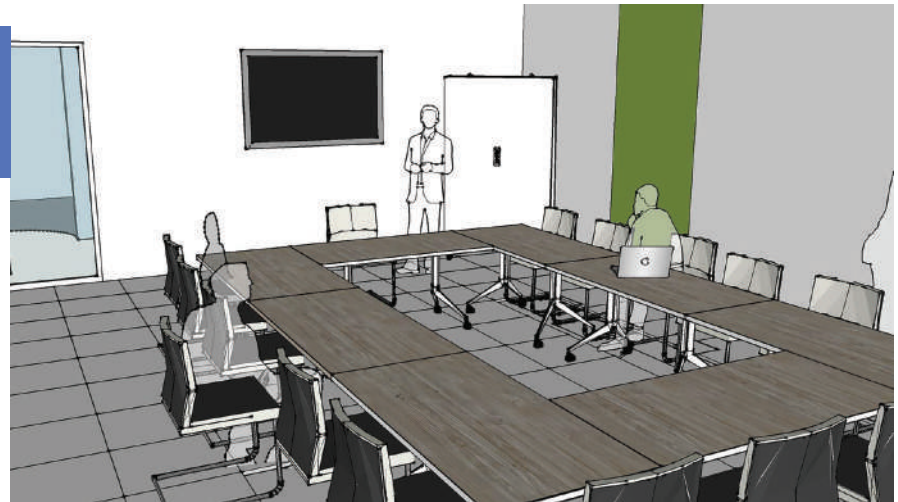

## IV

### Phase Four: Spirituality Center

#### Hunger to Gather & Grow in Faith and Service

Parishioners of all ages are benefiting from our many parish groups, which continue to grow and flourish every year:

- ▶ Adult Faith Formation
- ▶ Walking with Purpose
- ▶ Knights of Columbus
- ▶ Men's Gospel Reflection Group
- ▶ Bereavement Committee
- ▶ Friends of Mary
- ▶ Liturgy Committee
- ▶ Pro-Life
- ▶ St. Patrick Outreach

**“It was the many classes and events that were offered that increased my desire to become more involved.** Because of this, I met new friends—younger and older, male and female, who shared the same desire to have a better understanding of our faith. **There are many opportunities for each of us to grow in faith at St. Patrick Parish.”**

*—Marianne Charlton, Parishioner*



# Making Your Contribution to the Special Appeal

**Our plan to raise \$6 million has been fueled by the abundance of faith alive in our parish, and every donation goes directly to the goal of the appeal: growing together as a family of faith.**

**As we near the \$4 million milestone and prepare to move forward with plans to begin construction of the Early Childhood Education Center, we ask for your help in getting us over the finish line.**

*If you are ready to donate, please speak to Father Redcay. We are able to accept cash, checks, credit cards, donated securities, and online donations.*



## *Breastplate of St. Patrick*

Christ be with me, Christ within me,  
Christ behind me, Christ before me,  
Christ beside me, Christ to win me,  
Christ to comfort and restore me.  
Christ beneath me, Christ above me,  
Christ in quiet, Christ in danger,  
Christ in hearts of all that love me,  
Christ in mouth of friend and stranger.

I bind unto myself the Name,  
The strong Name of the Trinity;  
By invocation of the same.  
The Three in One, and One in Three,  
Of Whom all nature hath creation,  
Eternal Father, Spirit, Word:  
Praise to the Lord of my salvation,  
Salvation is of Christ the Lord.

*That we may continue growing  
as a family of faith!*

